

SUPERCON®

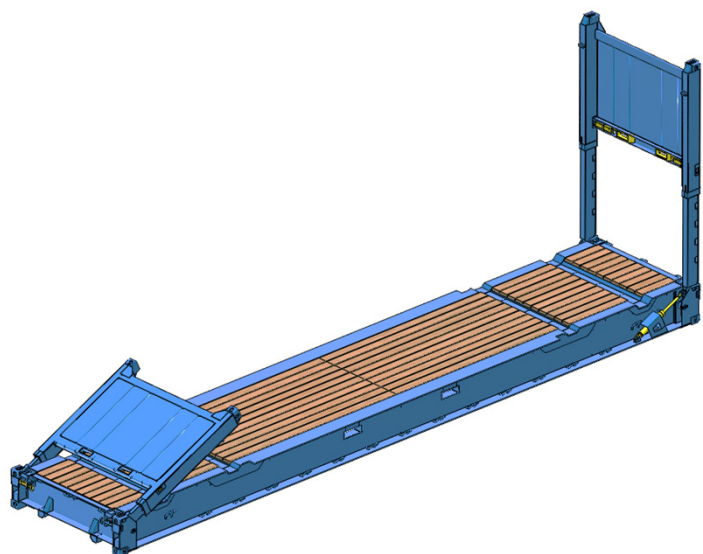

Specification		
External	Length	12,192 mm
	Width	2,438 mm
	Height	2,896 mm(9'6") to 4,421 mm(14'6") adjustable in 5 steps(305mm pitch)
Internal	Length	11,666 mm
	Width	2,328 mm
	Height	2,264 mm to 3,789 mm adjustable in 5 steps(305mm pitch)
Max. Payload		54,000 kg
Tare wt.		5,980 kg
Stacking		97,200 kg/post

※ This specification is subject to change without notice in order to improve quality.

WORKING PROCEDURE

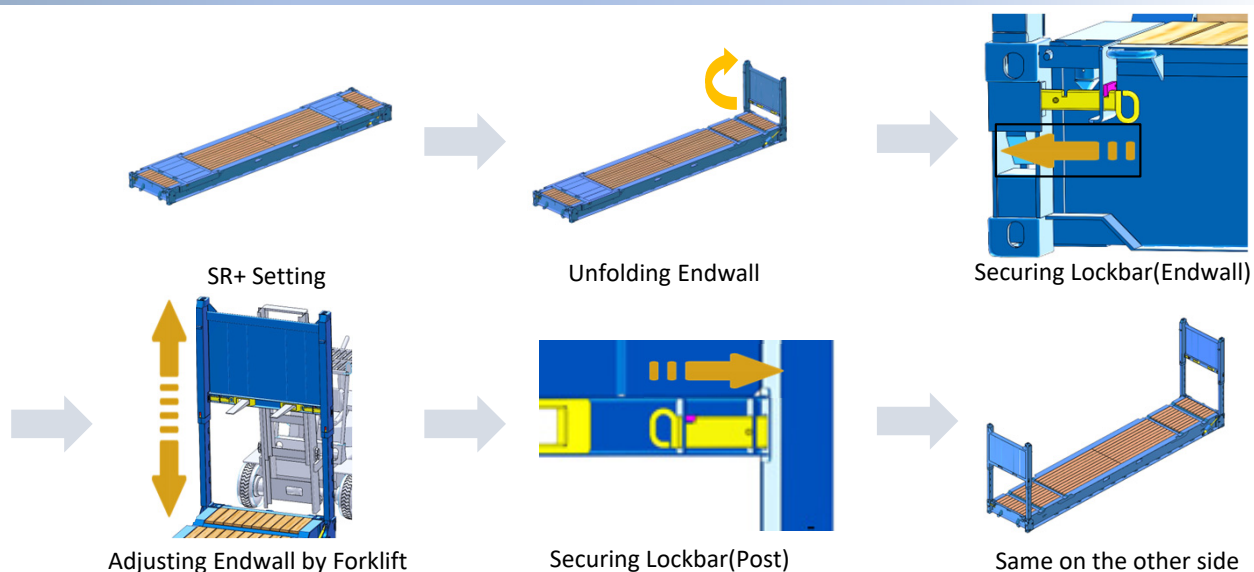

FEATURES

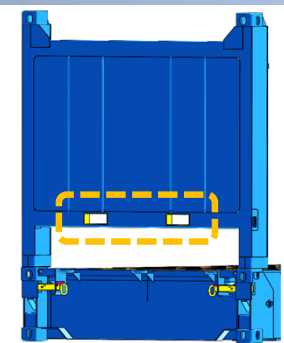

Forklift pocket on Endwall

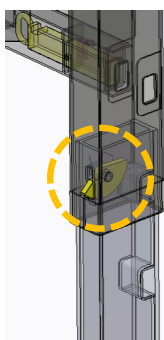

Emergency Stop Latch

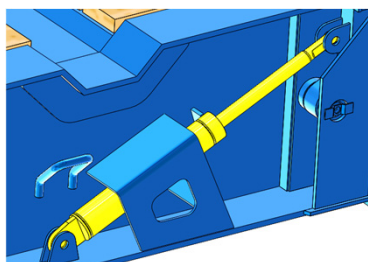

Cylinder For SR+
(2ea/box)

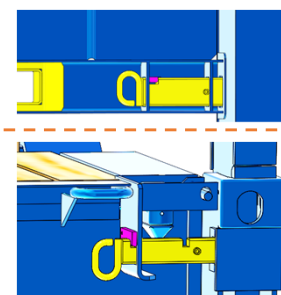

Easy to use Lockbar for
Post & Endwall
(4ea/box)